



Commercial Real Estate

Henry Road West



Acreage:
AVAILABLE

Zoning:
Commercial

Location:
Highway 31
and
Water Tower Road
North Myrtle Beach, SC

ALL REMAINING
ACREAGE FOR
COMMERCIAL
USE ONLY

- Close proximity to Barefoot Resort Developments.
- Less than 4 miles to the beautiful beaches of North Myrtle Beach.
- Less than 5 miles to shopping with Tanger Outlets, Colonial Mall, and Arcadian Shores Commons.
- Close proximity to Restaurant Row which caters to a variety of award winning restaurants.
- Horry County TMS# 155-00-01-053 PIN# 389-00-00-000.2

Please Contact Agent for Pricing

Contact us at:

E-mail: info@wacclt.com

Phone: 843-449-0441

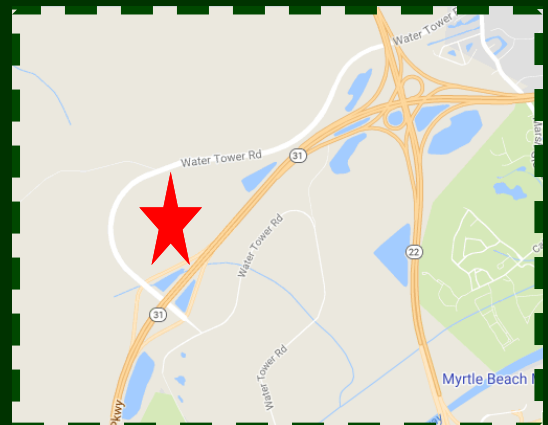

HENRY ROAD WEST

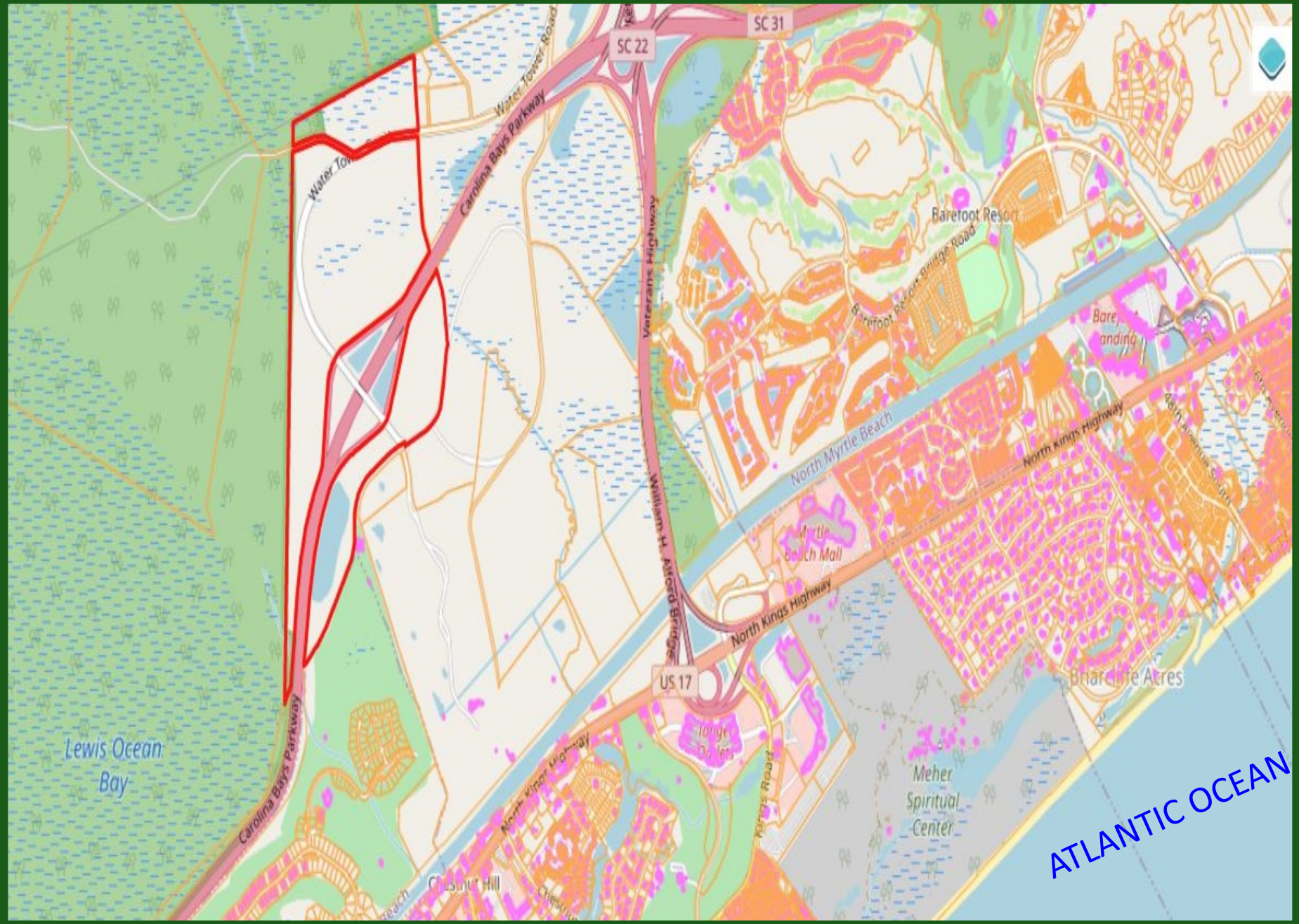

HENRY ROAD WEST

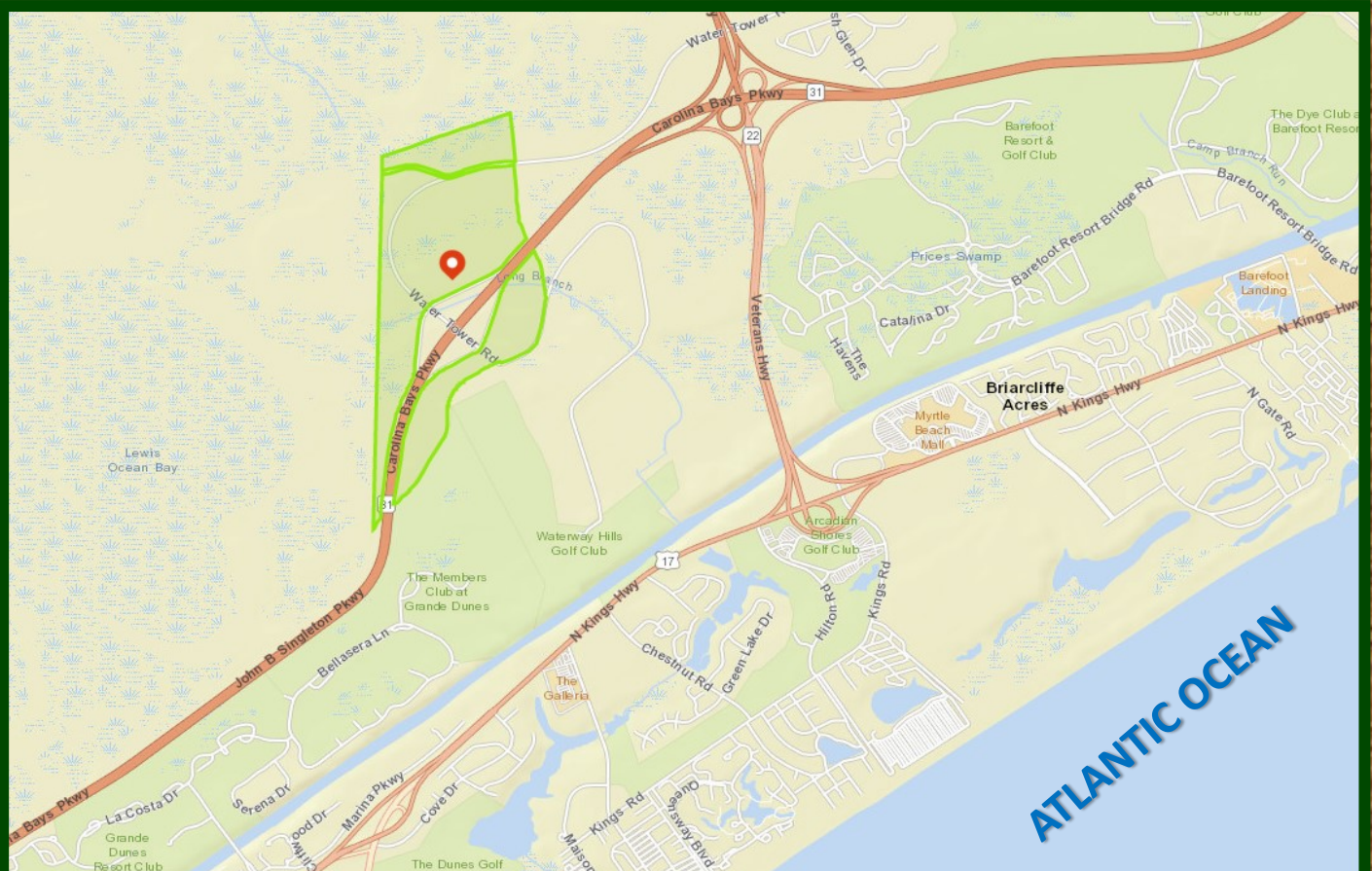

5/20/2024 4:37 PM



\\USERS\BAM\ISD\CHERRYPARKWAY\PROJ\PARKWAY_SALES\W\13.DWG

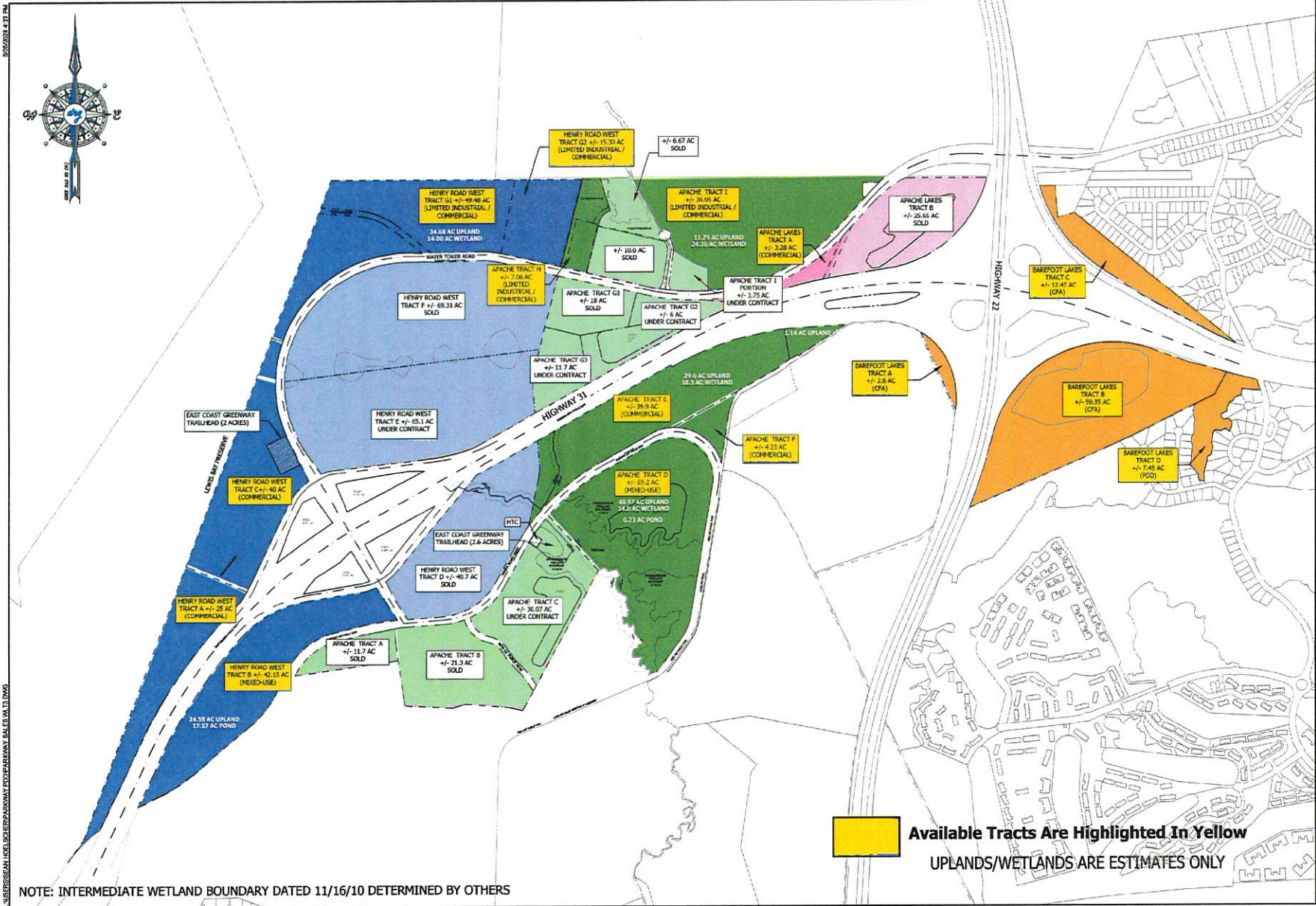

NOTE: INTERMEDIATE WETLAND BOUNDARY DATED 11/16/10 DETERMINED BY OTHERS

drq
 DEVELOPMENT RESOURCE GROUP, LLC
 4703 OLDFATHER DRIVE
 MYRTLE BEACH, SC 29577
 843-681-3366 | DRQPLC.COM

PARKWAY PARCELS

JOB NO:
 SCALE: 1"=500'
 DRAWN BY: SCH
 CHECKED BY: SCH
 DATE: 03/25/2024
 EXHIBIT NUMBER: